

17"X17"X24" TALL LIGHT BASES WITH HORN

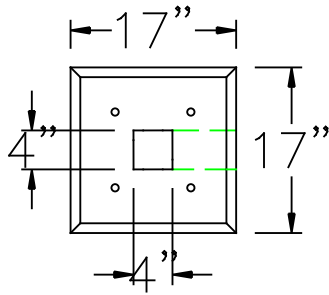

BOLT PROJECTION - 3"
 BOLT CIRICLE - 17"
 BOLTS - 1" X 24" GALV.

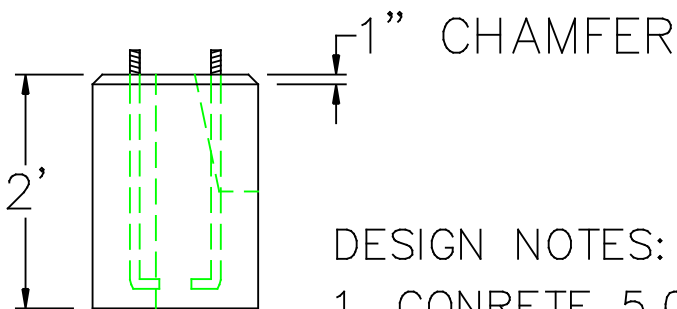

DESIGN NOTES:

1. CONCRETE 5,000 PSI @ 28 DAYS
2. REINFORCING ASTM A-615 GRADE 60
3. CONDUIT TO BE CAST AS SHOWN



NPCA

Precast ... The Concrete Solution.



SCITUATE RAY PRECAST
 120 CLAY PIT ROAD
 MARSHFIELD, MA 02050
 PHONE # 1-800-440-0009
 FAX # 781-837-4320

CONTRACTOR:

JOB NAME:

DATE:

DRAWING: SRP-LB171724

DRAWING BY:

C. J. SCOTT

WWW.SCITUATECOMPANIES.COM